

Community Design Charrette

UW Extension Community Vitality & Placemaking Team

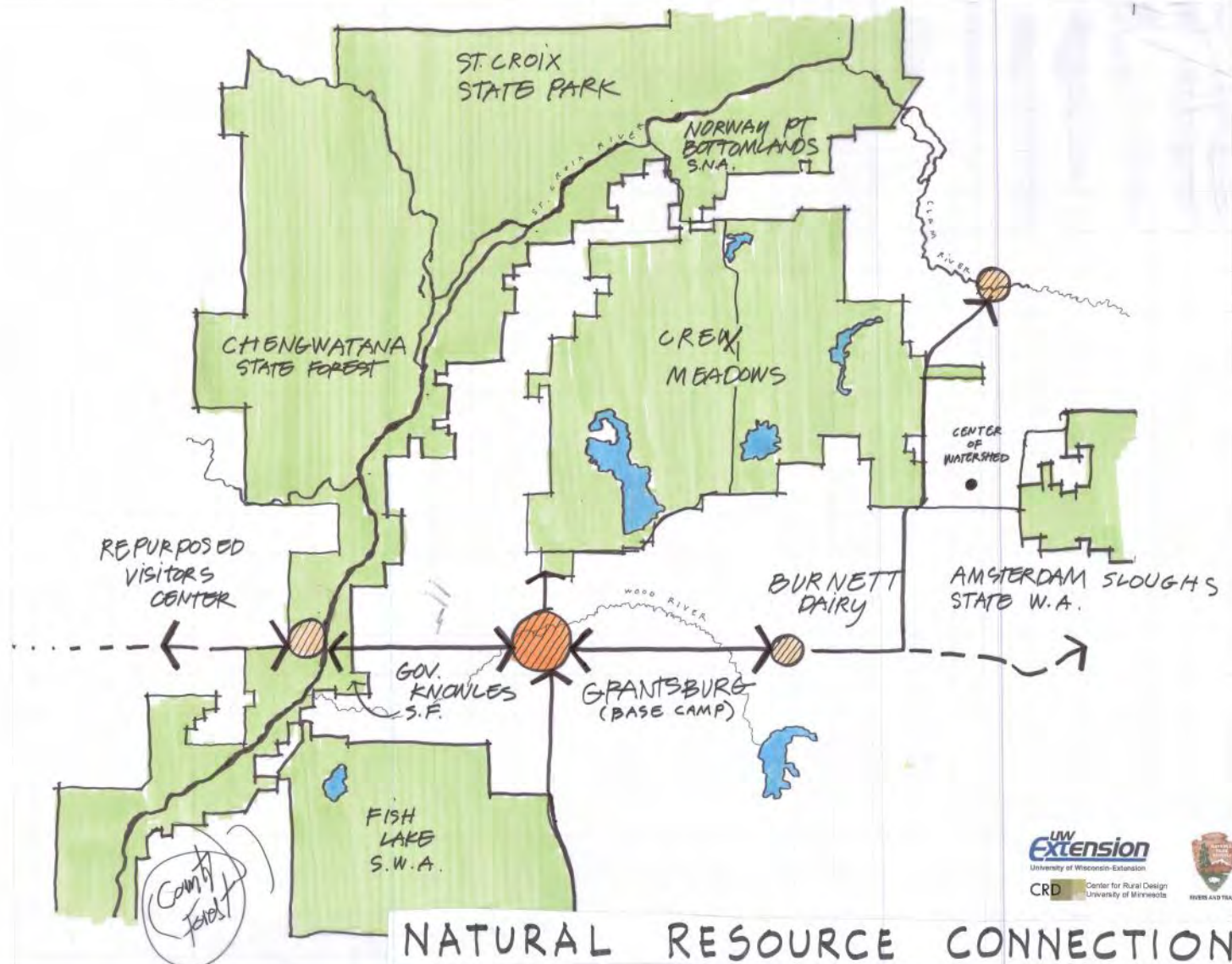

Community Design Charrette

UW Extension Community Vitality & Placemaking Team

LOCAL WELLNESS, SKI & RECREATIONAL BIKE ROUTES

MARKED BIKE ROUTES/WALKING ROUTES

- Olson Drive (Parkway) 0.9 MI. EACH WAY
- Park (Olson/Burnett) to H.S. 0.9 MI. EACH WAY

MAINTAINED TRAILS (CROSS COUNTRY)

- 7 km (4.3 mi.)
- 11 km (6.8 mi.) proposed

BIKE LOOPS - RECREATIONAL

- Crux Meadows West (Long) 26 MI. EST.
- Crux Meadows East (Mt. Bike) 26 MI. EST.
- Crux Meadows West (Short) 20 MI. EST.
- Fish Creek Wildlife Loop 25 MI. EST.
- Burnett Dairy Loop 13 MI. EST.

BIKE LOOPS REGIONAL/GANDY DANCER

- Yellow Lake Lollipop 46 MI. EST.
- Siren / Elbow Lake Loop 36 MI. EST.

CANOE / BOAT LANDINGS

- Canoe
- Boat

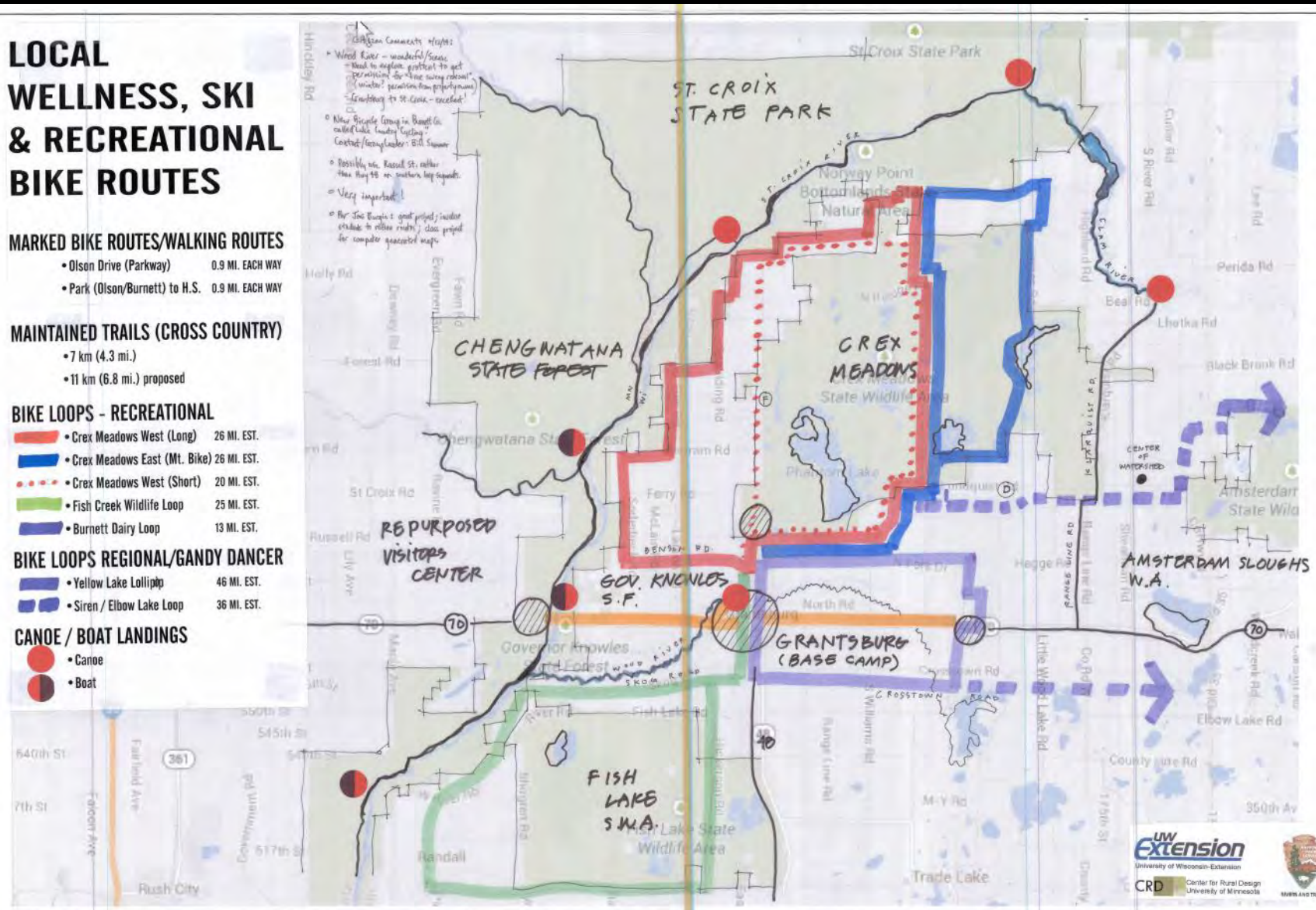

TRAILS AND RECREATIONAL ROUTES

Community Design Charrette

UW Extension Community Vitality & Placemaking Team

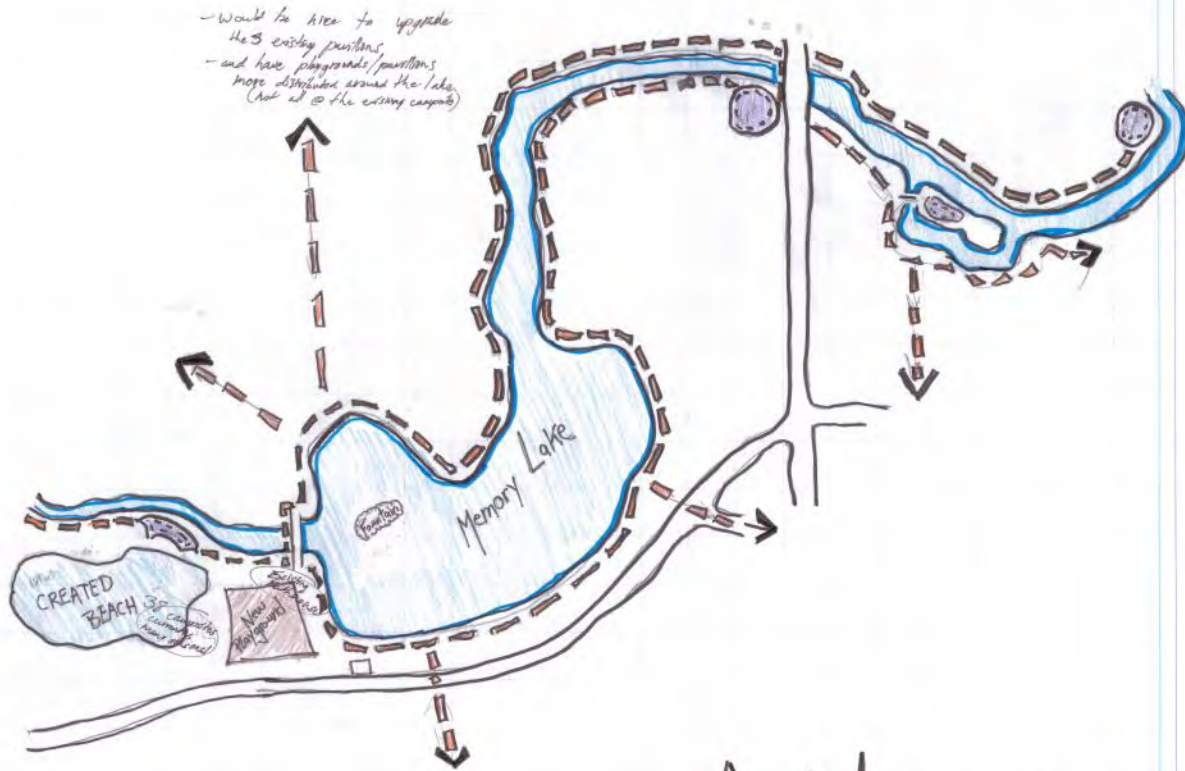

~ A VISION ~

UW
Extension

University of Wisconsin-Extension
CRD Center for Rural Design
University of Minnesota



A VISION FOR MEMORY LAKE AREA

Notes-

- Strolling Trail
- Information Kiosk
- Created Beach (shallow)
- Water Feature
- New Paved Playground



Community Design Charrette

UW Extension Community Vitality & Placemaking Team

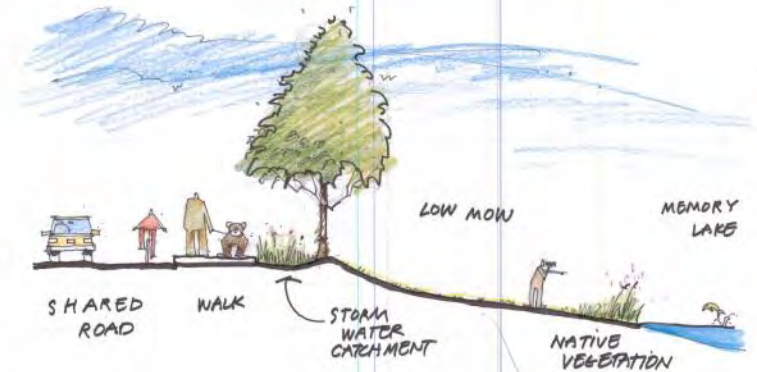
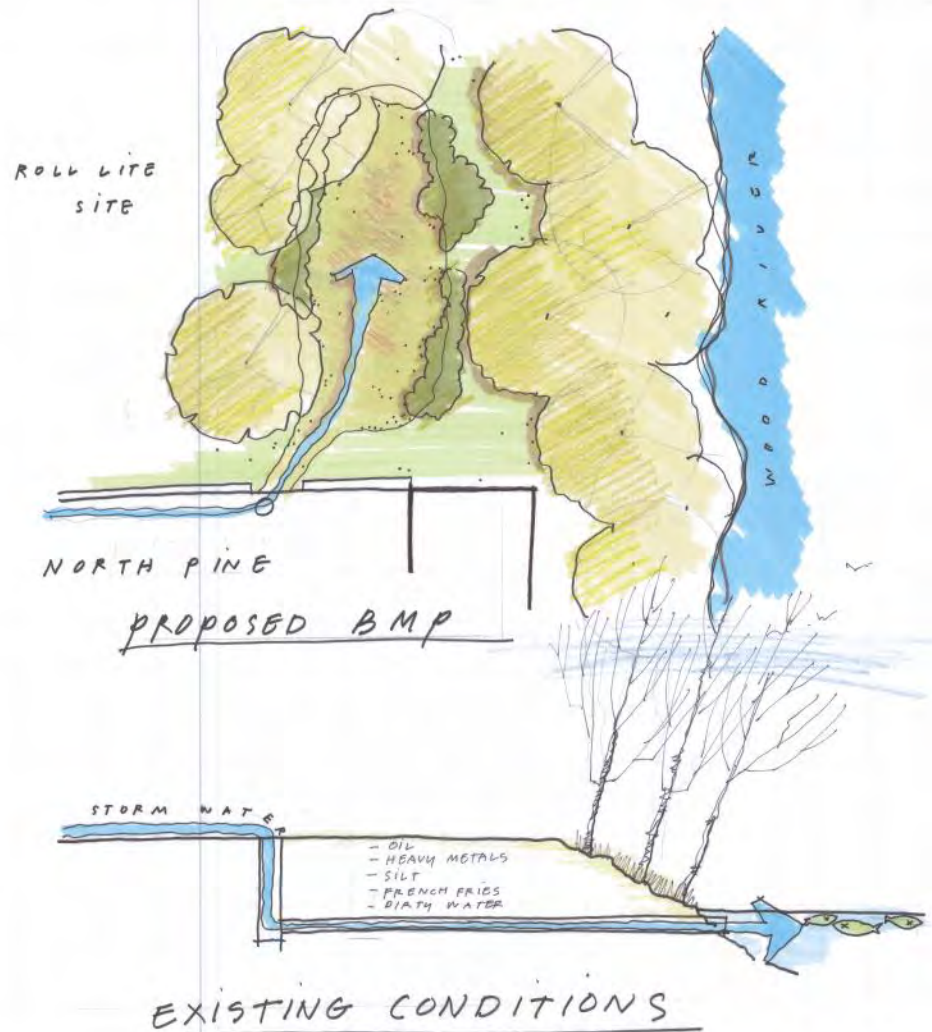

STORMWATER MANAGEMENT BEST PRACTICES

Community Design Charrette

UW Extension Community Vitality & Placemaking Team

BOOTS



Routes

- o Volunteer Enthusiasts: Ride potential routes and confirm/select best routes. Develop a map (paper & electronic) of 7-10 Recreational Bike Rides.

Health and Wellness

- o Hospital/Partners: Organize a "fitness challenge".

BOOTS



Environment and Storm Water

- o High School Biology: Construct a rain garden near Roll Lite Site.
- o Village Maintenance: Relandscape shore of Memory Lake with native vegetation and low maintenance turf.

* Girl Scouts too!

Vision-Memory Lake

- o Boy Scouts/Eagle Scouts: Identify walking route around Memory Lake and construct Information Kiosk.

BOOTS



Marshland Visitor Center

- o Brainstorm alternatives and initiate action.



April 2014

Natural Resources: First Steps

UW
Extension
University of Wisconsin - Extension



Community Design Charrette

UW Extension Community Vitality & Placemaking Team

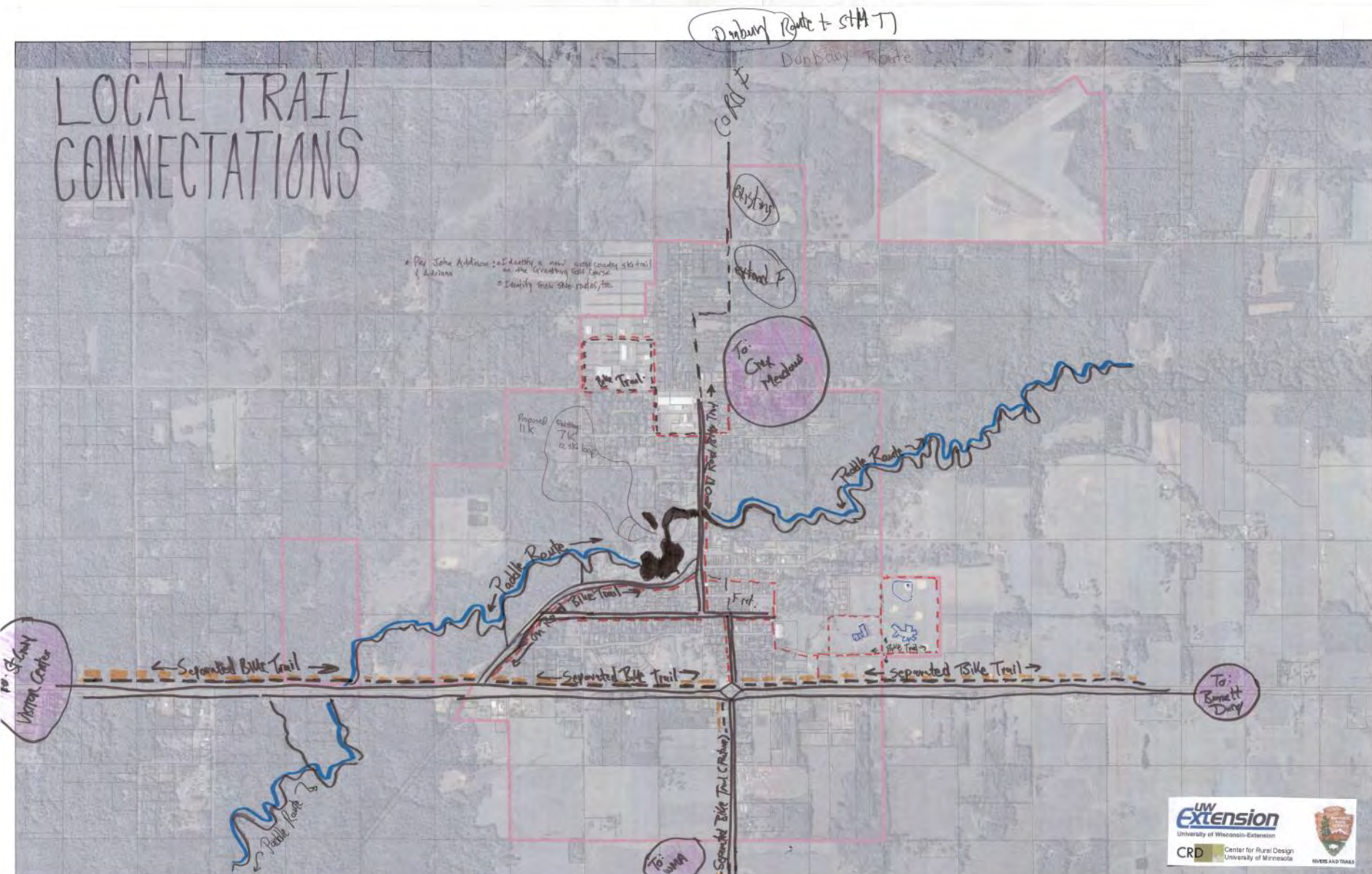

Community Design Charrette

UW Extension Community Vitality & Placemaking Team

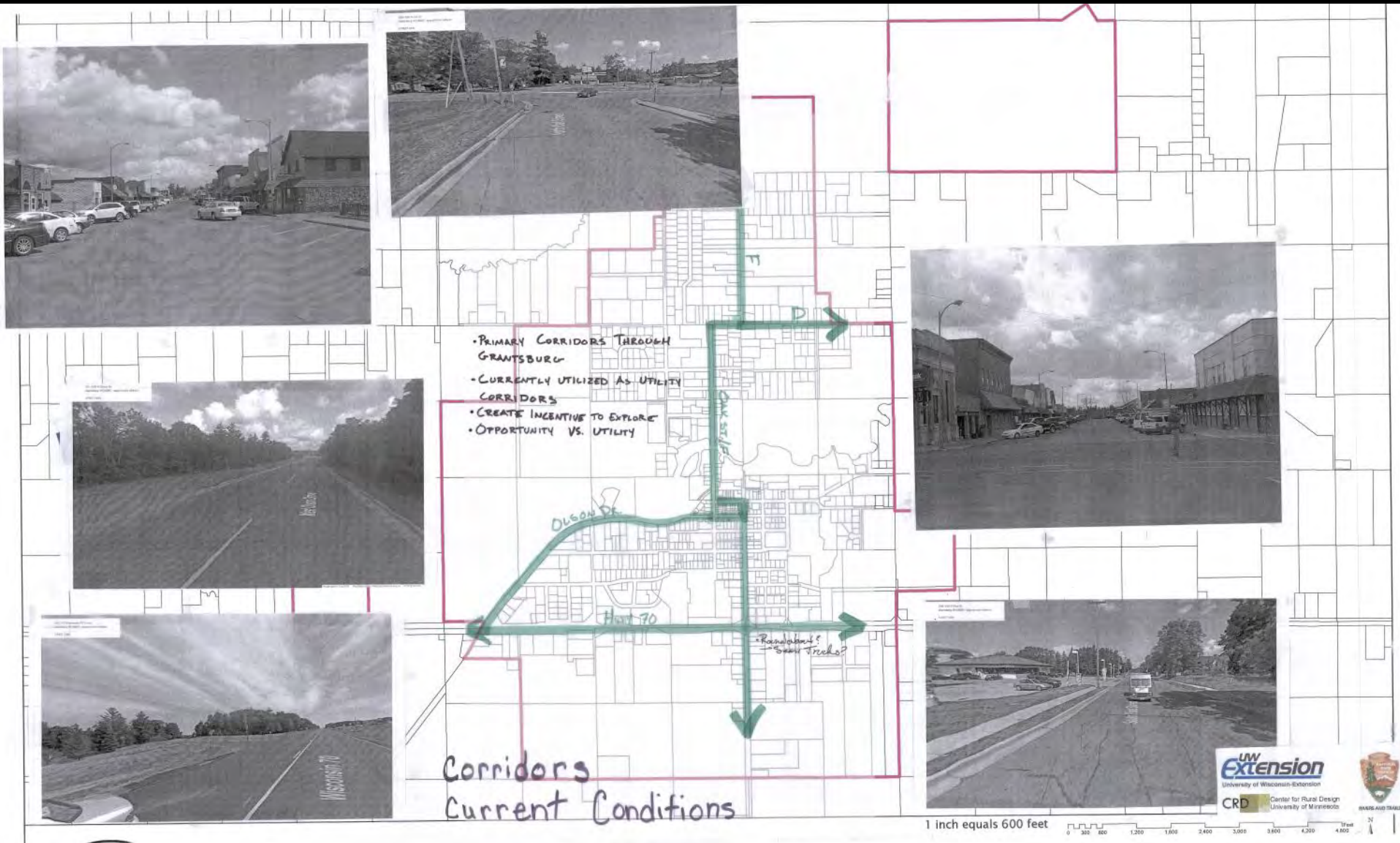

Community Design Charrette

UW Extension Community Vitality & Placemaking Team

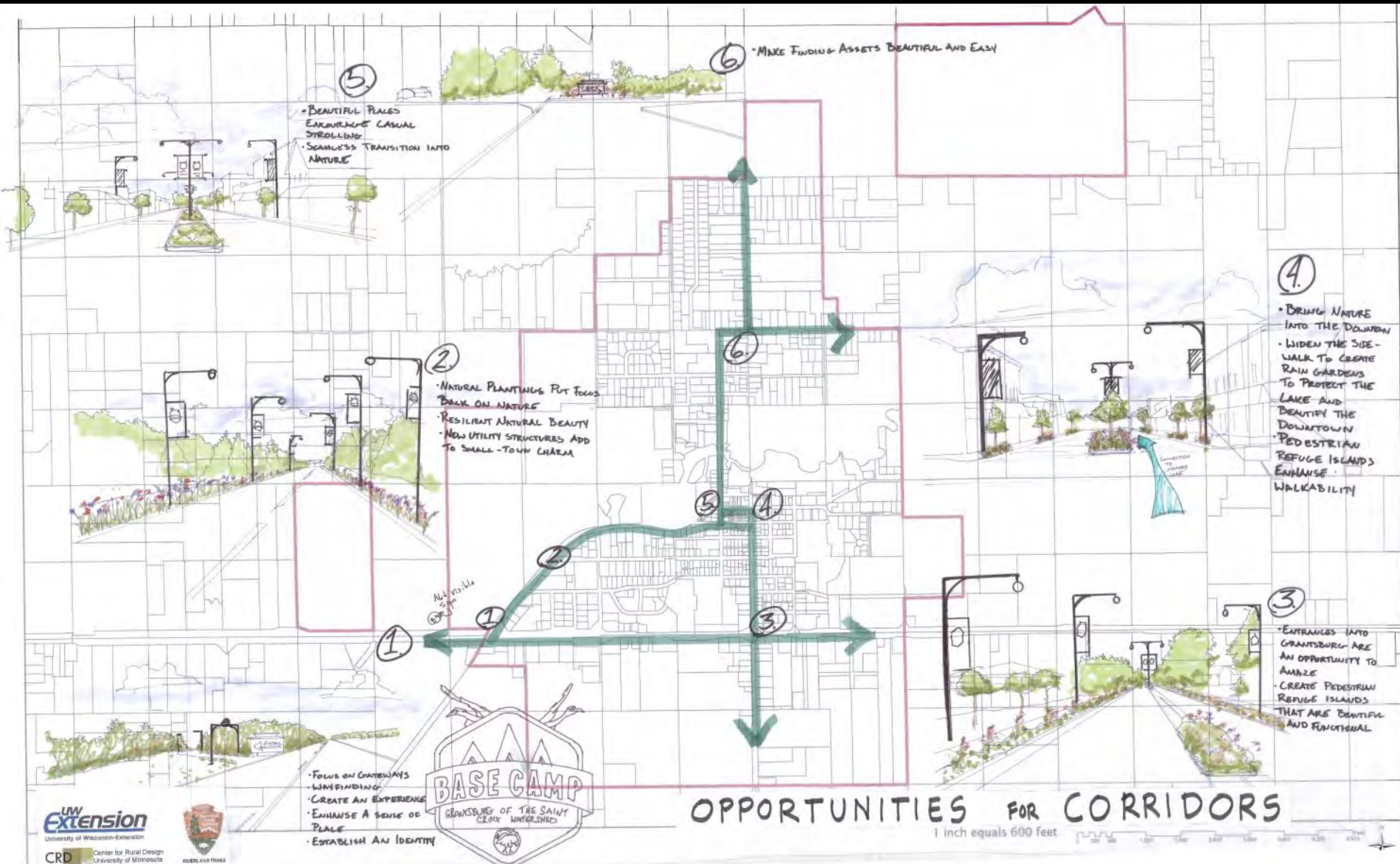

Community Design Charrette

UW Extension Community Vitality & Placemaking Team

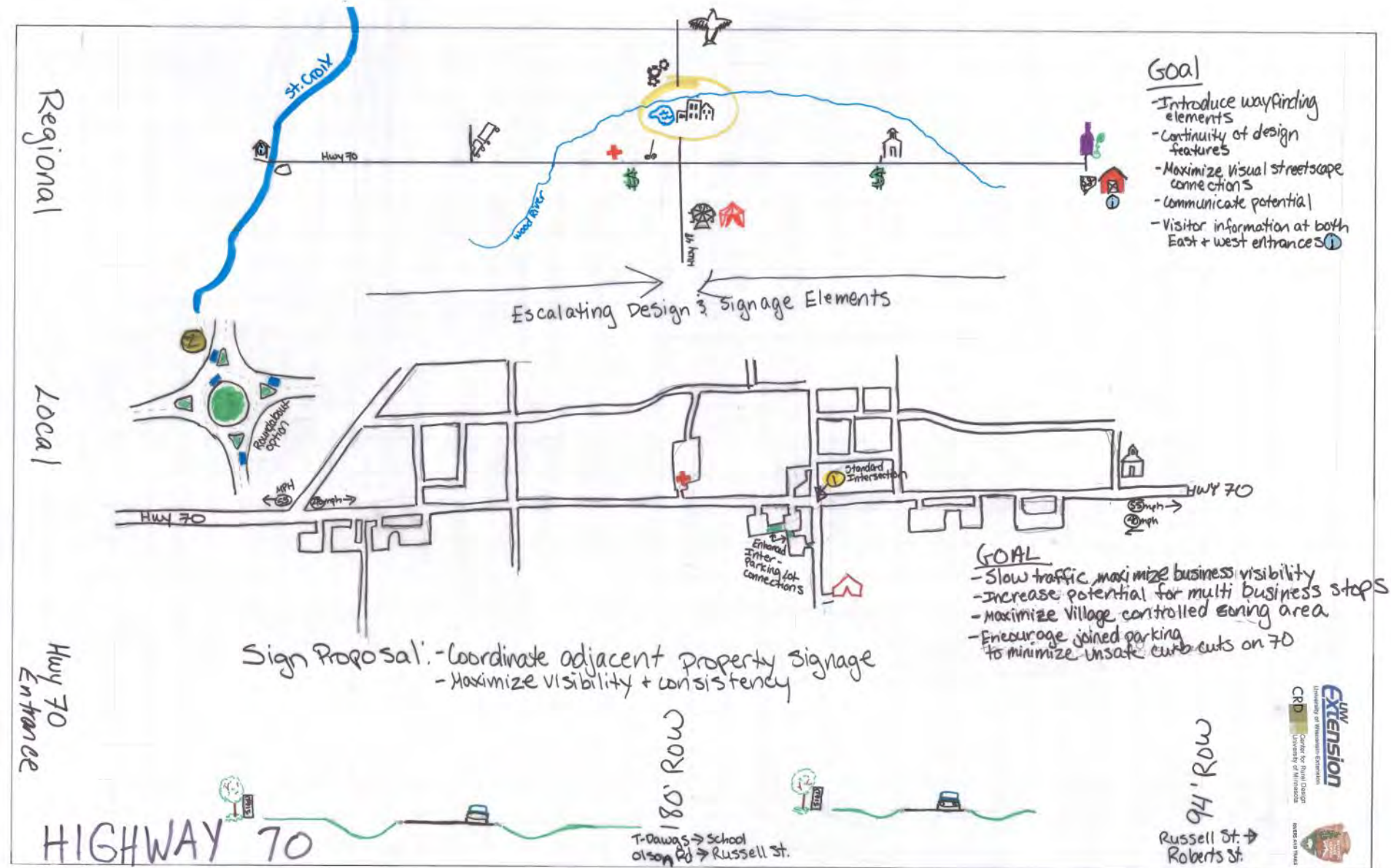

Community Design Charrette

UW Extension Community Vitality & Placemaking Team



CELEBRATE SESQUICENTENNIAL PUBLIC ART on PUBLIC WORKS

A
LOW-COST
ACTIVITY to DO (soon)
as a COMMUNITY

- DONATED MATERIALS/PAINT...
- DONATED TIME...
- Could be done as a contest, fundraiser, workday/event...

Makes a
LASTING IMPRESSION







... other ideas:
DECORATIVE...

- murals
- sculptures
- bike racks
- public benches
- trail sign posts







... something
GRANTSBURG COULD
DO NOW to
strengthen
COMMUNITY SPIRIT



April 2014





Community Design Charrette

UW Extension Community Vitality & Placemaking Team

BOOTS



- ✓ WAYFINDING SIGNAGE
 - PLANNING AND INSTALLATION
- ✓ OLSON DRIVE + PINE STREET
 - ENTRANCE PLANTINGS
- ✓ COORDINATE SHARED SIGNAGE
 - ON HIGHWAY 70
- ✓ VISITOR INFO
 - AT BURNETT DAIRY + ST CROIX CENTER + CREX MEADOWS
- ✓ PIRATE FLAG
- ✓ ROLL-LITE DEMO
- ✓ WILDLIFE VIEWING



April 2014

DOWNTOWN AND HWY 70



Community Design Charrette

UW Extension Community Vitality & Placemaking Team



Community Design Charrette

UW Extension Community Vitality & Placemaking Team

SITE
PLAN

- EXPANDABLE VIA MULTIPLE ACCESSORY USES
- 2,000 SF. TO START PLUS MORE



THE
EXPANDER



- 1,200 SF. HOUSE
- MULTIPLE DWELLINGS ON BIG LOTS

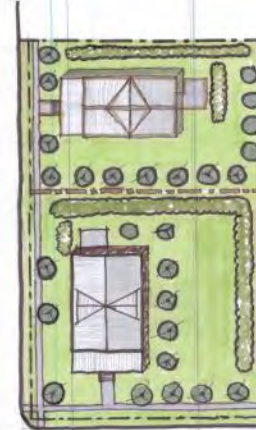

SITE
PLAN

THE
GRANTSBURG



April 2014

SINGLE

FAMILY

HOUSING



Community Design Charrette

UW Extension Community Vitality & Placemaking Team

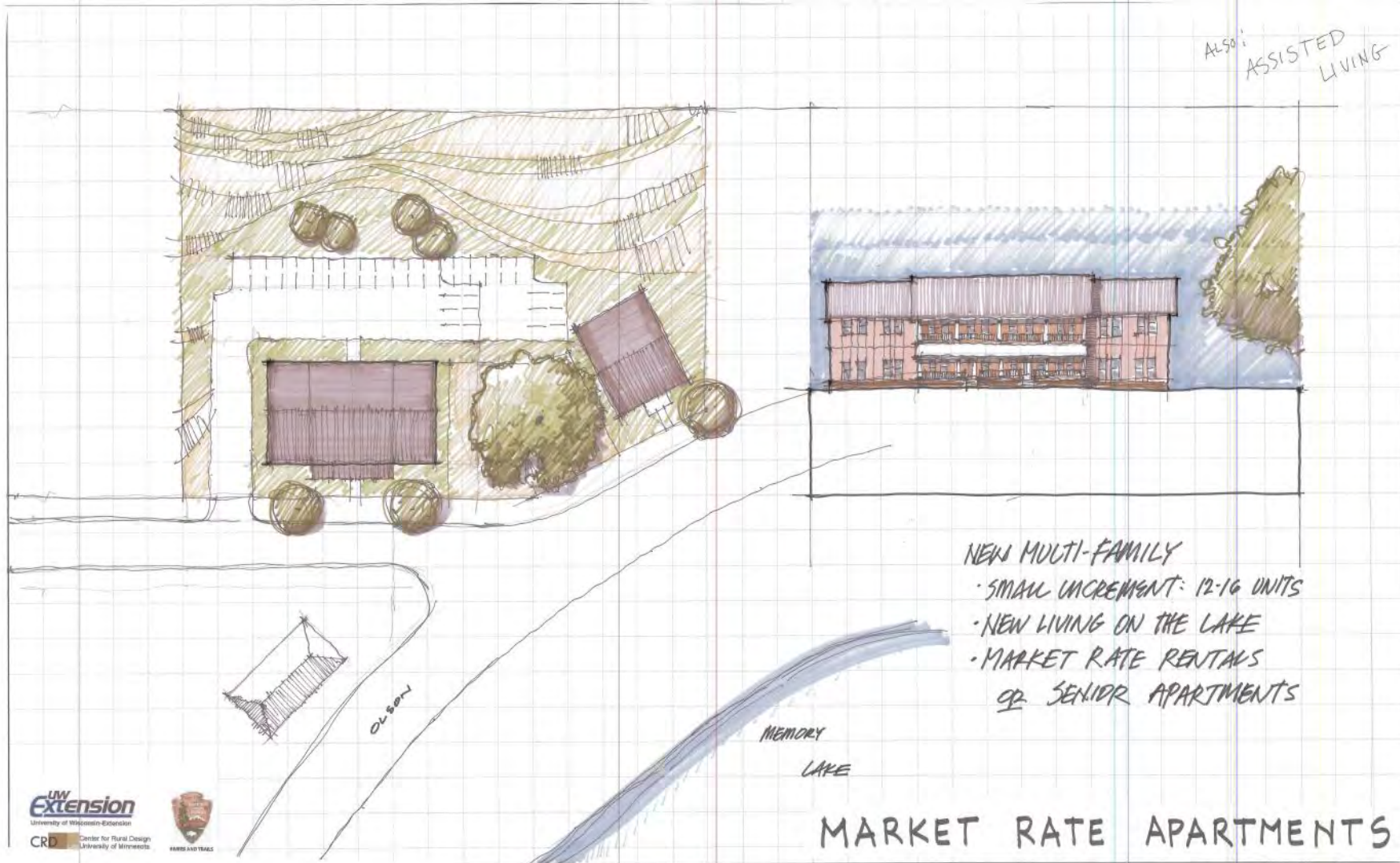

Community Design Charrette

UW Extension Community Vitality & Placemaking Team



April 2014

POCKET NEIGHBORHOOD



Community Design Charrette

UW Extension Community Vitality & Placemaking Team

BOOTS



ON THE GROUND

- ✓ HELP A SENIOR w/ YARDWORK
- ✓ NEIGHBORHOOD PAINT DAY
- ✓ FLOWERS + HANGING BASKETS

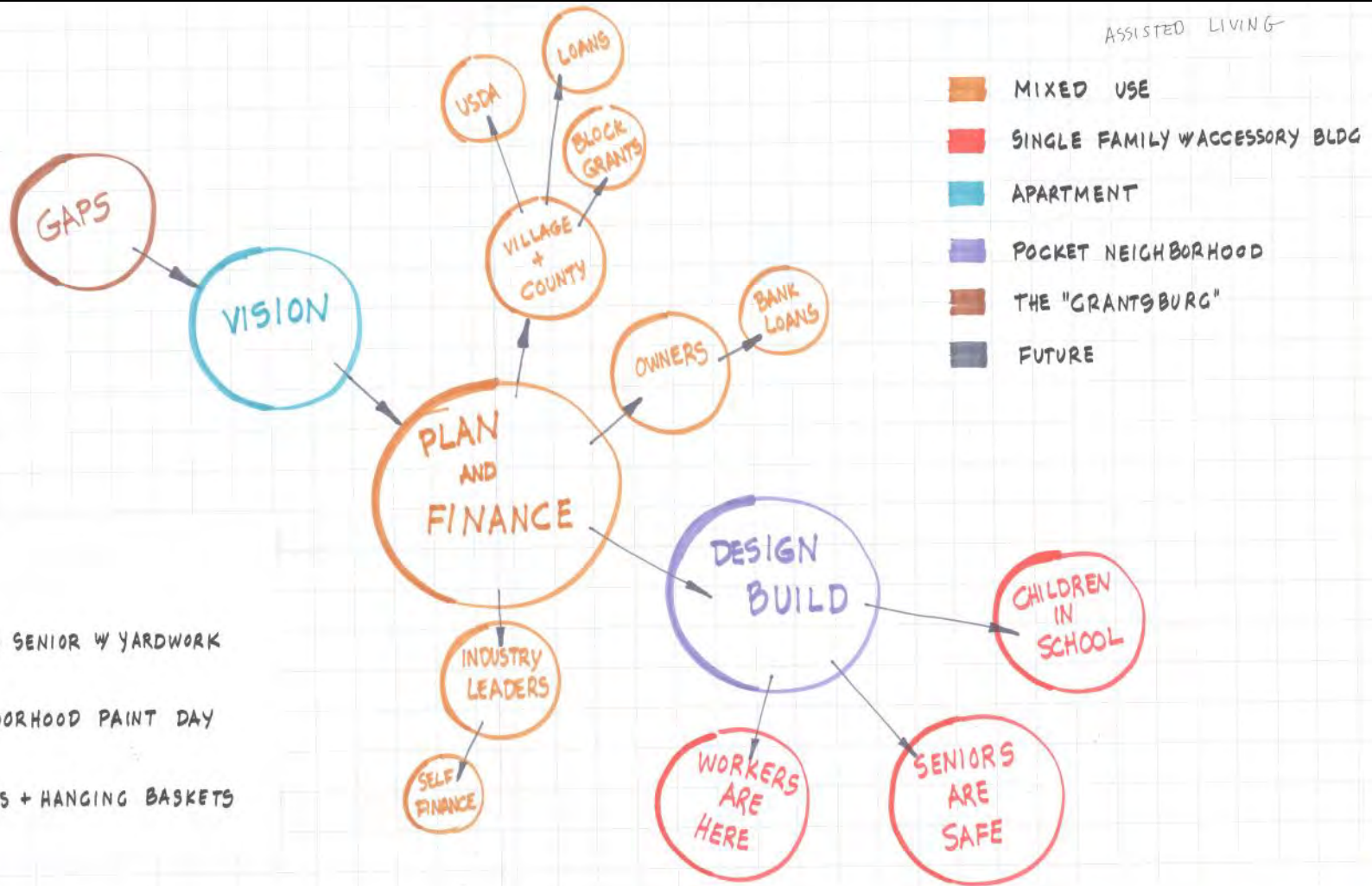

April 2014

HOUSING "TO-DO" LIST



Community Design Charrette

UW Extension Community Vitality & Placemaking Team

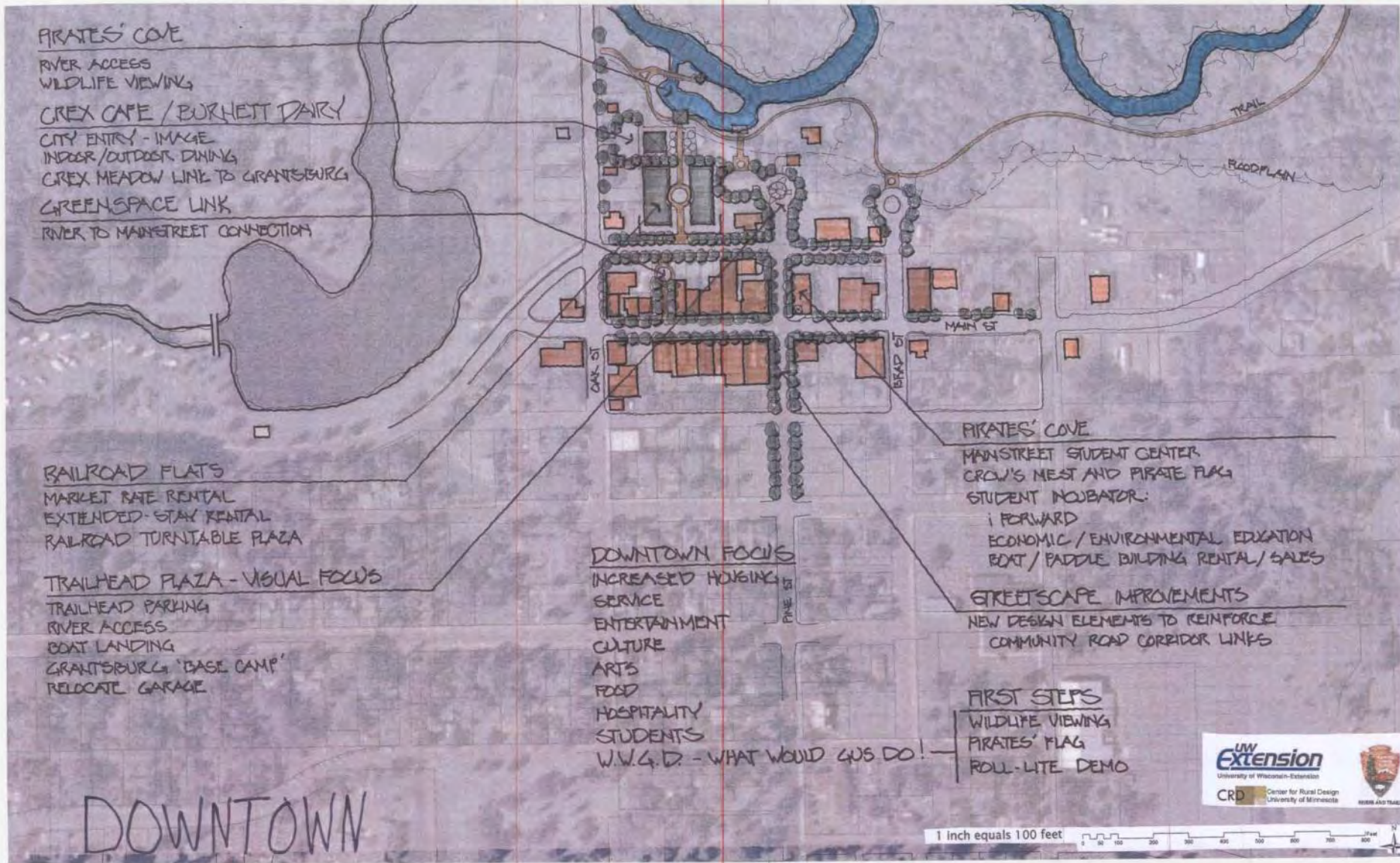

Community Design Charrette

UW Extension Community Vitality & Placemaking Team

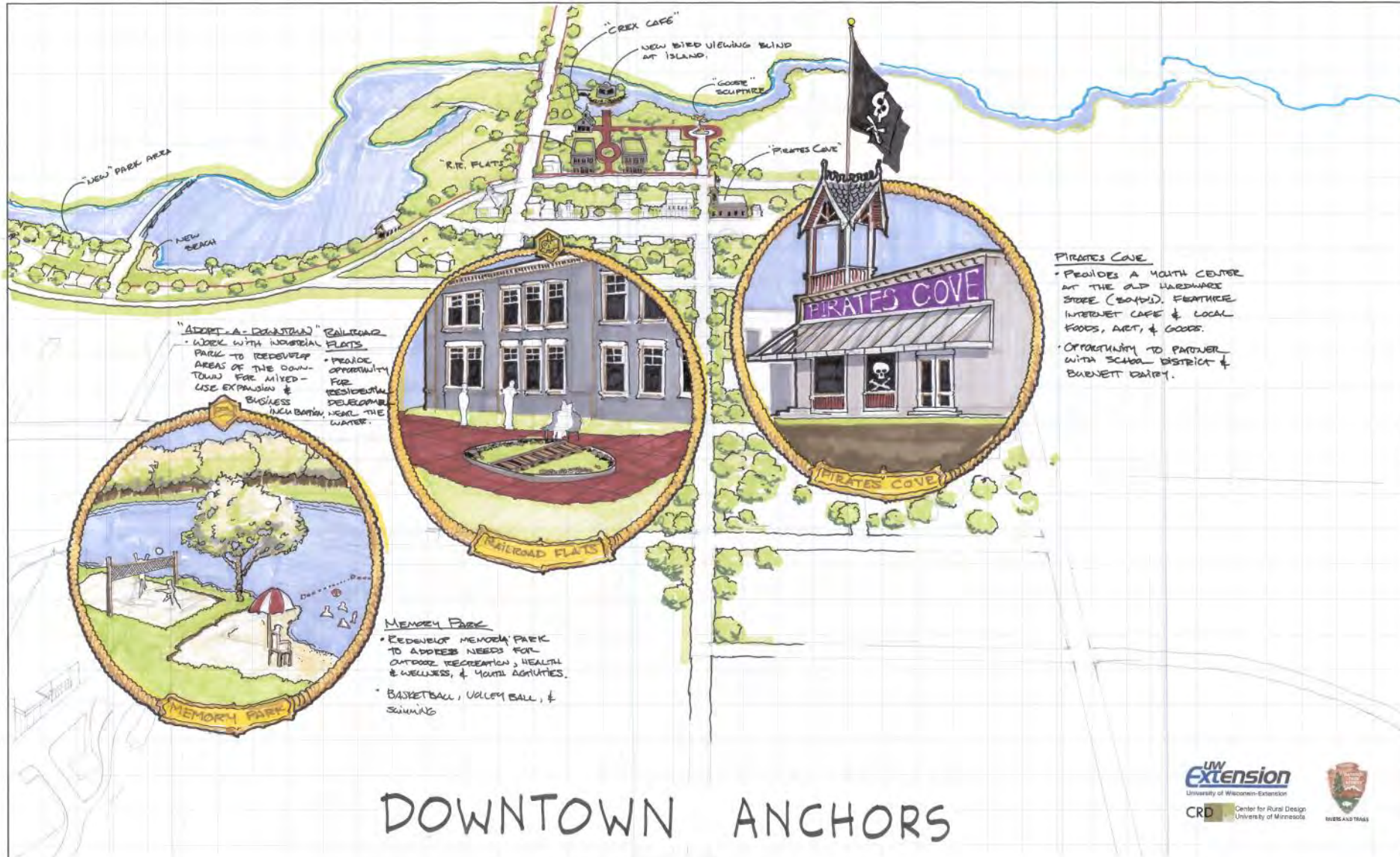

Community Design Charrette

UW Extension Community Vitality & Placemaking Team

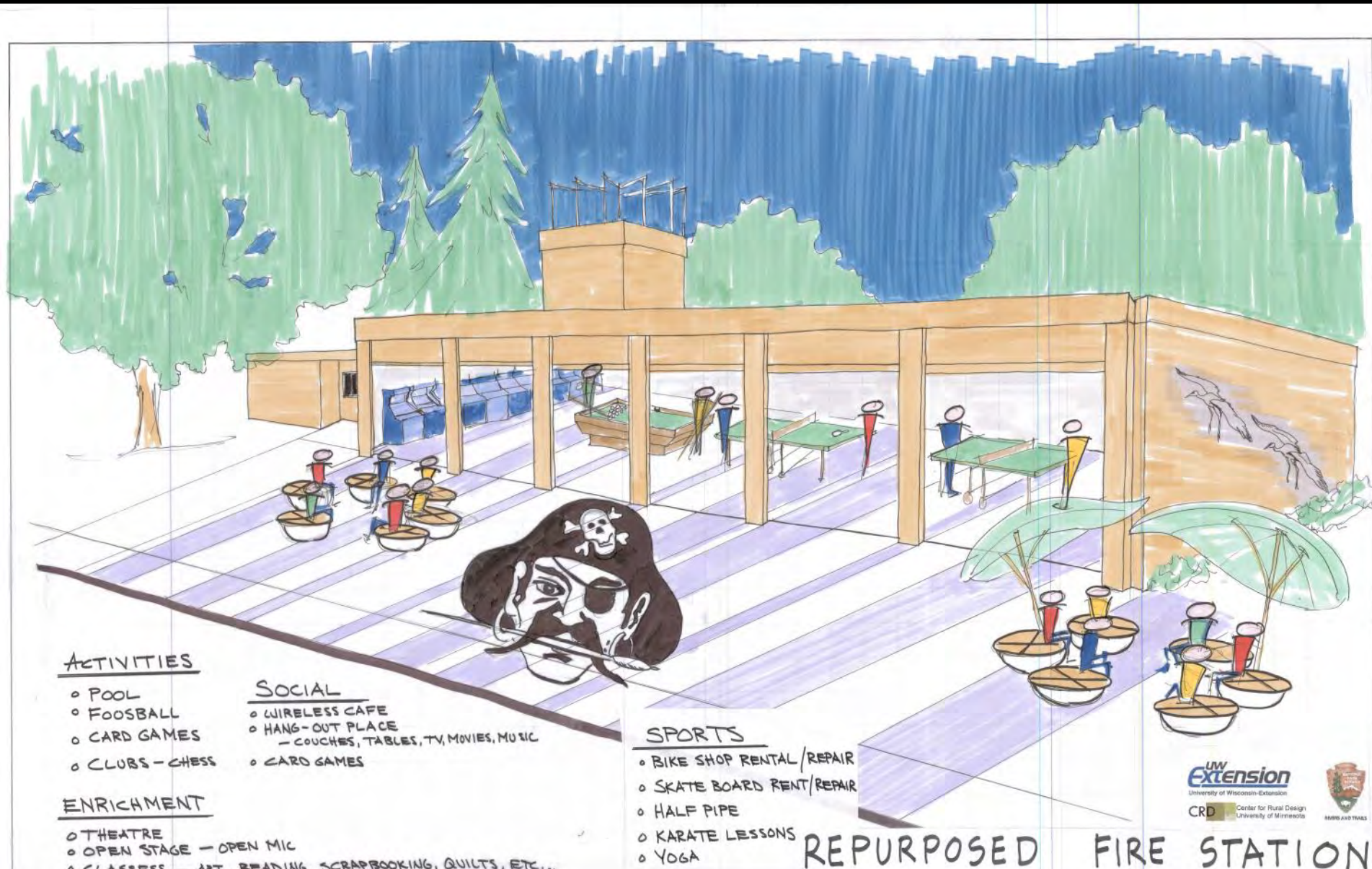

UW Extension Community Vitality & Placemaking Team

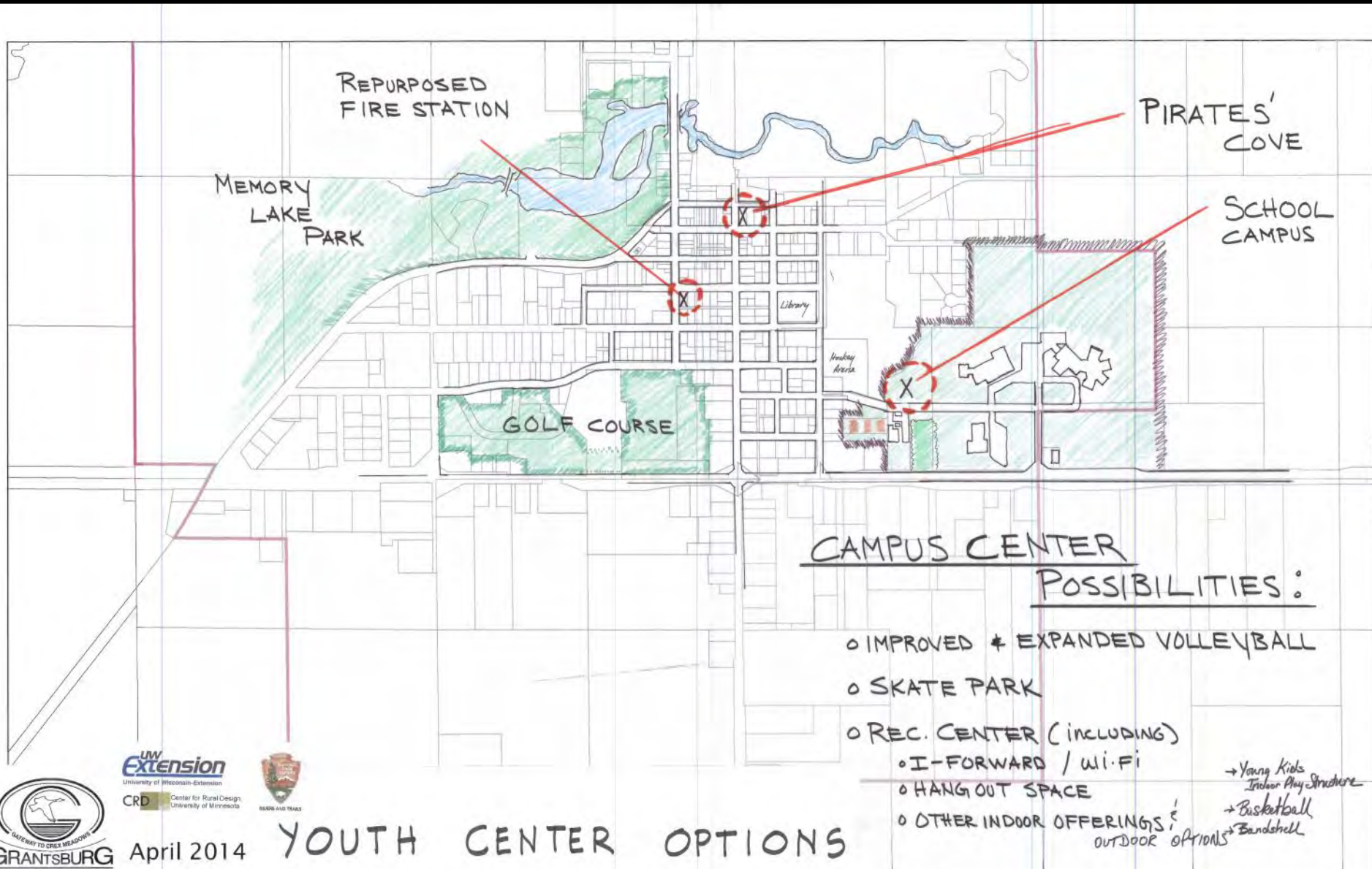

Community Design Charrette

UW Extension Community Vitality & Placemaking Team

PROCESS STEPS



PRINCIPLES

- VISION GUIDES ACTIONS
- NO SINGLE ENTITY IN CHARGE
- SELF DIRECTED COMMUNITY ACTION
 - CAPABILITY
 - PASSION / ENERGY
 - READINESS TO ACT

IMPLEMENTATION

